



The following section provides detailed information on assembling your SLEEP NUMBER® waterbed replacement mattress.

before you begin

These instructions are for converting a standard hard side waterbed frame. If you have a non-standard frame you may need to make modifications to these instructions.

Before Draining Your Waterbed

It is very important to check the contents of your mattress boxes against the list on page 9. If you are missing any items listed on the following page, please e-mail Customer Service at customerservice@selectcomfort.com or call 1-800-472-7185.

Prepare Your Foam Comfort Pad

If you purchased a Pillowtop model, carefully open the Foam Comfort Pad and set it aside.
NOTE: At least 20 minutes of expansion time is needed.

Orientation

These instructions refer to “left” and “right” as if you are standing at the head of the bed looking towards the foot of the bed.

NOTE: Assembly of this mattress in your existing waterbed frame requires the use of a small saw and an electric drill. Be sure you have these tools available before you begin.

We had a waterbed for years. We both sleep much better. Even our two dogs like it better.

*Ronald B.
Lewisville, TX*

NOTE: Super sizes only

contents

Carefully check the contents of your mattress boxes and compare with the list below.

Mattress Cover

2 parts zipped together

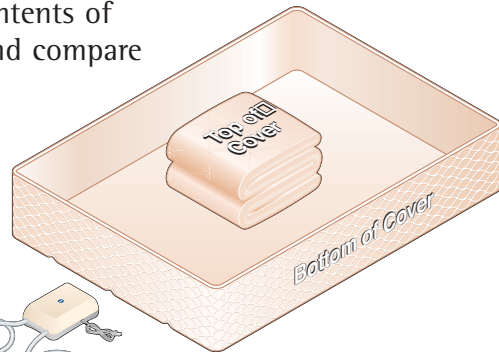

Firmness Control™ System



Remote(s)

Varies by model. See pages 1043 for more detail.

Sleep Number® Firmness Control™ System
(1 wired)



Sleep Number® Firmness Control™ System 5000
(2 wired or 1 wireless)



All single chamber models include 1 remote only.
Wired remotes will be attached to the Firmness Control™ System.

Foam Riser Pads

Queen/King Size

Quantity: 8

Twin Size

Quantity: 4

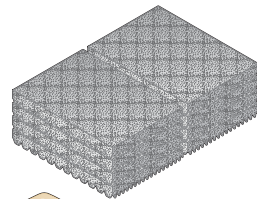

Air Chamber(s)

2 for dual chamber models

1 for single chamber models

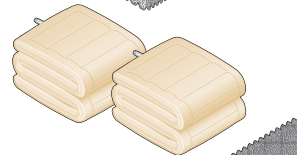

Center Foam Wall

Dual chamber models only

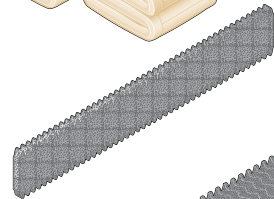

Foam Comfort Pad

Pillowtop models only

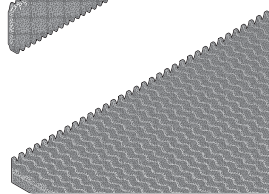

If you are missing any items, please e-mail Customer Service at customerservice@selectcomfort.com or call 1-800-472-7185.

1 Prepare Pedestal Base

- After you have checked to make sure you have all the components, drain waterbed and remove.
- Remove wood panel(s) that the mattress rests on.
- Using a saw, cut a hole approximately 1" high and 3" wide in the head of the pedestal base.

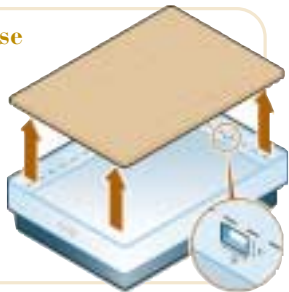

2 Position Firmness Control System

- Place the FIRMNESS CONTROL SYSTEM™ on the floor inside the pedestal base.
- Feed the power cord and remote(s) through the hole cut in the head of the pedestal base.
- Plug the Firmness Control System™ into an electrical outlet. (The Sleep Number Firmness Control System™ with a digital remote will beep to indicate that it is on.)

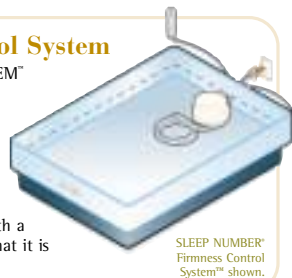

SLEEP NUMBER™ Firmness Control System™ shown.

Where are the Caps for Air Chamber(s)?

The caps are in the Firmness Control System™ box. Please store these should you ever want to disassemble your bed and temporarily cap your air chamber(s).

What if my Foam Comfort Pad appears to be too small or irregular?

Gently shake the pad as you place it on your mattress and it will recover its full size overnight.

What do I do if the motor doesn't run?

Check to see if the power cord is plugged into an outlet which has power and is not connected to an on/off wall switch.

Will my bed deflate if there is a power surge or power loss?

No, your mattress will maintain its firmness. To protect your Firmness Control System™, we do recommend using a surge protector.

What if I notice a rubber smell from the air chamber?

The odor you may smell is non-toxic and will fade over time. To minimize the smell, allow the air chamber to air out for a few hours and then lay a couple of dryer sheets on top of the air chamber.

3 Drill Hole(s) for Air Hose(s)

- Return the wood panel(s) to their original location.
- Temporarily lay your air chamber(s) on top of the wood panel(s) with the attached hose connector(s) facing the head of the bed.
- Use the hose connector(s) as a guide to help you determine where to drill the hole(s) for the air hose(s).
- Feed the air hose(s) through the hole(s). (For the dual Sleep Number Firmness Control System™, the hose marked with an "L" connects to the left air chamber and the other hose connects to the right air chamber.)

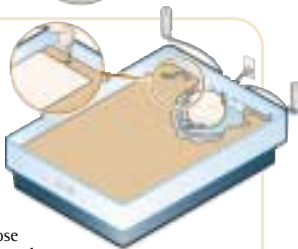

4 Install the Foam Riser Pads

- Place the grey FOAM RISER PADS flat side up in the mattress pedestal base.
- Pull the hose(s) up so that they lay on top of the Riser Pads.



Queen/King model shown.

5 Position Mattress Cover and Install the Air Chambers

- Place MATTRESS COVER (quilted side up) inside the bed frame.
- Unzip the top of the cover and set it aside.
- Position the cover so that the hole(s) in the underside of the cover are at the head of the mattress.
- Lay the AIR CHAMBER(s) inside the Mattress Cover so the hose connector(s) are on the bottom and face the head of the bed. The connector(s) will roughly align with the small openings at the base of the cover.



Dual chamber mattress shown.

6 Connect Firmness Control System and Inflate the Air Chamber(s)

- Pass the end of each hose through the small opening at the base of the Mattress Cover and connect it to its corresponding air chamber.
- Press "Firmer" (up arrow button) on the remote to activate the hand control. The display will blink several times. When the blinking stops, set the firmness to "20." Inflation may take about 15 minutes.

(For the standard Firmness Control System™, simply press the "Firmer" button on the remote to begin inflating the mattress.)

- For dual chamber models, after the first chamber is inflated, repeat for second chamber. Then, insert the CENTER FOAM WALL between the chambers, centering it between the head and foot of the bed.

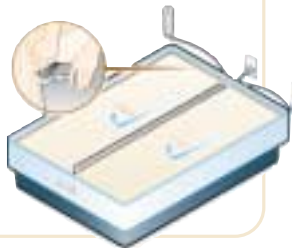

7 Install Foam Comfort Pad (Pillowtop models only)

- Carefully shake out the pad prior to placing in position.
- Place the FOAM COMFORT PAD on top of the Air Chamber(s) with the "zones" facing up and clipped ends at the head of the bed. Center it so that it fits within the pedestal base.



Final Step

- Zip on the top of the MATTRESS COVER.

You're Done!

Now go to the Finding Your Comfort Level section to customize your Sleep Number® bed.

