

# Lifestyle Collection Furniture

## REMOTE PAIRING INSTRUCTIONS



### GETTING STARTED

The remotes need to charge before they can be paired. Ensure the red switch on the control panel of the headboard is powered "On". Dock both remotes and let them charge for 3-5 minutes before pairing.

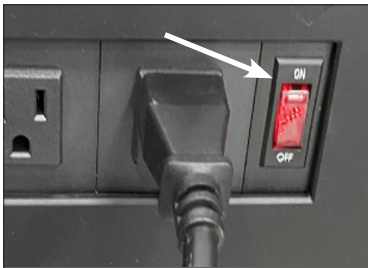

### STEP 1

Remove both remotes from their charging dock. You will need to have the remote in hand before you enter pairing mode.

### STEP 2

Pairing Mode - Turn the red switch off, wait 3 seconds and turn it back on. **You now have 10 seconds to pair the remote to the bed.**



### STEP 3

- Press any button to wake the remote (buttons will light up)
- Press and hold the POWER button until the backlights start flashing rapidly, then release the button.

Pairing is successful if the flashing stops completely. If the lights flash slowly, pairing was not successful. Repeat Steps 1 and 2.



### STEP 4

You can confirm the remote is paired by checking to see if the SYNC light is illuminated.

You can also confirm the remote is paired by pressing POWER button to control the Sleep/Wake light on the back of the headboard.

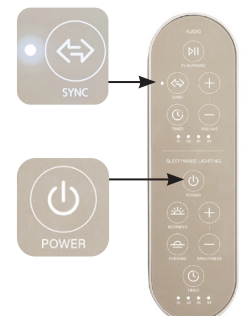

### STEP 5

Pair the other remote by following steps 2-4.